

## USE AND CARE GUIDE

### 4in./6in. New Construction Fire Rated Recessed Housing

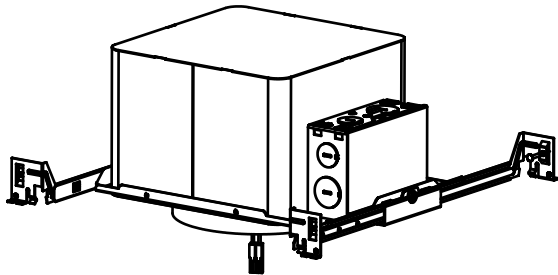

1

## INSTALLATION

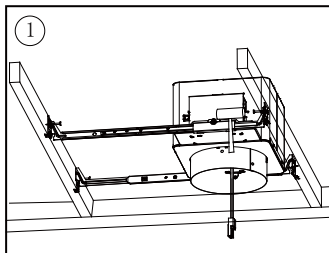

1. Put the construction can on one side and fix the brackets with nails.

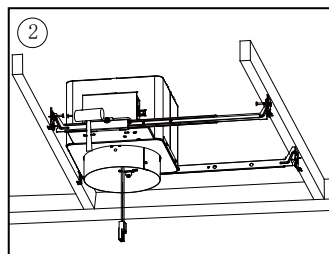

2. Repeat step 1, put the construction can on another side fix the brackets with nails.

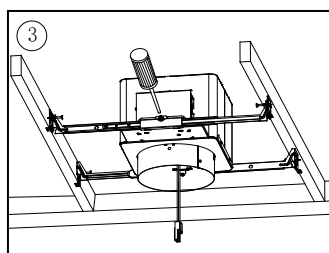

3. Move the construction can to the proper location and screw it.

3

## SAFETY INSTRUCTION

**WARNING:** For safety, read and understand instructions completely before starting installation. Electricity should be turned off at the fuse or the circuit breaker box before installing the fixture. All electrical connections must be in accordance with Electrical Code and local electrical code.

**CAUTION:** DISCONNECT POWER BEFORE CONNECTING TRIM TO HOUSING. FAIL TO DO SO MAY PERMANENTLY DAMAGE THE LED.

## WARRANTY

This product is warranted for 5 years from the date of purchase. If this product does not perform to the specifications supplied on this package send an email to [support@lightingsquared.com](mailto:support@lightingsquared.com) for return or replacement. This replacement is the sole remedy available. Liability for incidental or consequential damage is expressly excluded.

## TOOLS REQUIRED

- Saw
- Measuring tape
- Electrical wiring (use type and gauge suitable for application to connect the fixtures).

## Tools Required



NOTE: Keep your receipt and these instructions for Proof of Purchase.



Ladder



Gloves



Phillips Screwdriver



Wire Stripper

2

## INSTALLATION

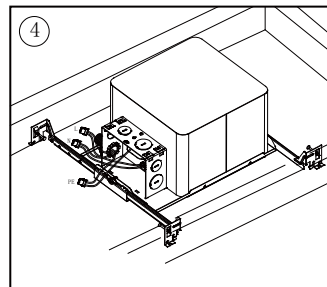

4. Knock out the knock hole and assemble the flexible metal conduit. Open the junction box, and connect the house wire accurately according to the instruction. The black wire connects to the fire wire, the white wire connects to the middle wire, and the ground wire connects to the green wire.

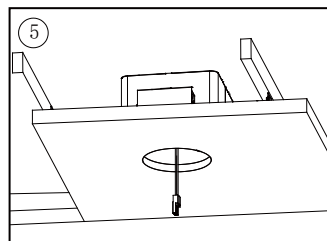

5. Assembly the ceiling and use the template hole to dig out an installation hole in the installation location. Finally connect the fixture to be installed with the construction can. You can use lighting housing smoothly!

4