



LIGHTING SQUARED



BOX 20 C SHOWN
FOR CLARITY

BOX 20 W SERIES

A minimal geometric form designed to accent the current modern design. An electrostatically applied powdercoat for a durable finish. Special colors are available upon request for additional appearances. .

The BOX 20 Series is an energy efficient design capable of using both LED or more traditional light sources. This family of luminaires has companion ceiling and pendent versions, the wall version utilizing a discreet canopy for use with a 3.5" octagon box.

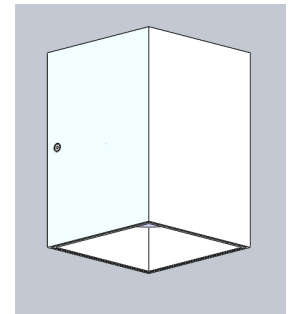
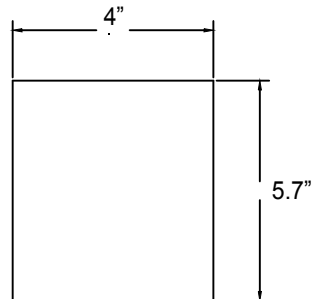

DESIGN OPTIONS

MODEL	FINISH	MOUNTING	VOLTAGE		LIGHT SOURCE
BOX 20 W	COLOR	WALL - INTERIOR	120		1 X PAR20/PAR35 35 WATT MAXIMUM

